

Short Environmental Assessment Form

Part 1 - Project Information

Instructions for Completing

Part 1 - Project Information. The applicant or project sponsor is responsible for the completion of Part 1. Responses become part of the application for approval or funding, are subject to public review, and may be subject to further verification. Complete Part 1 based on information currently available. If additional research or investigation would be needed to fully respond to any item, please answer as thoroughly as possible based on current information.

Complete all items in Part 1. You may also provide any additional information which you believe will be needed by or useful to the lead agency; attach additional pages as necessary to supplement any item.

Part 1 - Project and Sponsor Information				
Name of Action or Project:				
Project Location (describe, and attach a location map):				
Brief Description of Proposed Action:				
Name of Applicant or Sponsor:		Telephone:		
		E-Mail:		
Address:				
City/PO:		State:	Zip Code:	
1. Does the proposed action only involve the legislative adoption of a plan, local law, ordinance, administrative rule, or regulation? If Yes, attach a narrative description of the intent of the proposed action and the environmental resources that may be affected in the municipality and proceed to Part 2. If no, continue to question 2.			NO	YES
2. Does the proposed action require a permit, approval or funding from any other governmental Agency? If Yes, list agency(s) name and permit or approval:			NO	YES
3.a. Total acreage of the site of the proposed action? _____ acres				
b. Total acreage to be physically disturbed? _____ acres				
c. Total acreage (project site and any contiguous properties) owned or controlled by the applicant or project sponsor? _____ acres				
4. Check all land uses that occur on, adjoining and near the proposed action.				
<input type="checkbox"/> Urban <input type="checkbox"/> Rural (non-agriculture) <input type="checkbox"/> Industrial <input type="checkbox"/> Commercial <input type="checkbox"/> Residential (suburban)				
<input type="checkbox"/> Forest <input type="checkbox"/> Agriculture <input type="checkbox"/> Aquatic <input type="checkbox"/> Other (specify): _____				
<input type="checkbox"/> Parkland				

5. Is the proposed action, a. A permitted use under the zoning regulations?	NO	YES	N/A
b. Consistent with the adopted comprehensive plan?			
6. Is the proposed action consistent with the predominant character of the existing built or natural landscape?	NO	YES	
7. Is the site of the proposed action located in, or does it adjoin, a state listed Critical Environmental Area? If Yes, identify: _____ _____	NO	YES	
8. a. Will the proposed action result in a substantial increase in traffic above present levels?	NO	YES	
b. Are public transportation service(s) available at or near the site of the proposed action?			
c. Are any pedestrian accommodations or bicycle routes available on or near site of the proposed action?			
9. Does the proposed action meet or exceed the state energy code requirements? If the proposed action will exceed requirements, describe design features and technologies: _____ _____	NO	YES	
10. Will the proposed action connect to an existing public/private water supply? If No, describe method for providing potable water: _____ _____	NO	YES	
11. Will the proposed action connect to existing wastewater utilities? If No, describe method for providing wastewater treatment: _____ _____	NO	YES	
12. a. Does the site contain a structure that is listed on either the State or National Register of Historic Places? b. Is the proposed action located in an archeological sensitive area?	NO	YES	
13. a. Does any portion of the site of the proposed action, or lands adjoining the proposed action, contain wetlands or other waterbodies regulated by a federal, state or local agency? b. Would the proposed action physically alter, or encroach into, any existing wetland or waterbody? If Yes, identify the wetland or waterbody and extent of alterations in square feet or acres: _____ _____ _____	NO	YES	
14. Identify the typical habitat types that occur on, or are likely to be found on the project site. Check all that apply: <input type="checkbox"/> Shoreline <input type="checkbox"/> Forest <input type="checkbox"/> Agricultural/grasslands <input type="checkbox"/> Early mid-successional <input type="checkbox"/> Wetland <input type="checkbox"/> Urban <input type="checkbox"/> Suburban			
15. Does the site of the proposed action contain any species of animal, or associated habitats, listed by the State or Federal government as threatened or endangered?	NO	YES	
16. Is the project site located in the 100 year flood plain?	NO	YES	
17. Will the proposed action create storm water discharge, either from point or non-point sources? If Yes, a. Will storm water discharges flow to adjacent properties? <input type="checkbox"/> NO <input type="checkbox"/> YES b. Will storm water discharges be directed to established conveyance systems (runoff and storm drains)? If Yes, briefly describe: <input type="checkbox"/> NO <input type="checkbox"/> YES _____ _____	NO	YES	

<p>18. Does the proposed action include construction or other activities that result in the impoundment of water or other liquids (e.g. retention pond, waste lagoon, dam)?</p> <p>If Yes, explain purpose and size: _____</p> <p>_____</p> <p>_____</p>	<p>NO</p>	<p>YES</p>
<p>19. Has the site of the proposed action or an adjoining property been the location of an active or closed solid waste management facility?</p> <p>If Yes, describe: _____</p> <p>_____</p> <p>_____</p>	<p>NO</p>	<p>YES</p>
<p>20. Has the site of the proposed action or an adjoining property been the subject of remediation (ongoing or completed) for hazardous waste?</p> <p>If Yes, describe: _____</p> <p>_____</p> <p>_____</p>	<p>NO</p>	<p>YES</p>
<p>I AFFIRM THAT THE INFORMATION PROVIDED ABOVE IS TRUE AND ACCURATE TO THE BEST OF MY KNOWLEDGE</p> <p>Applicant/sponsor name: _____ Date: _____</p> <p>Signature: _____</p>		

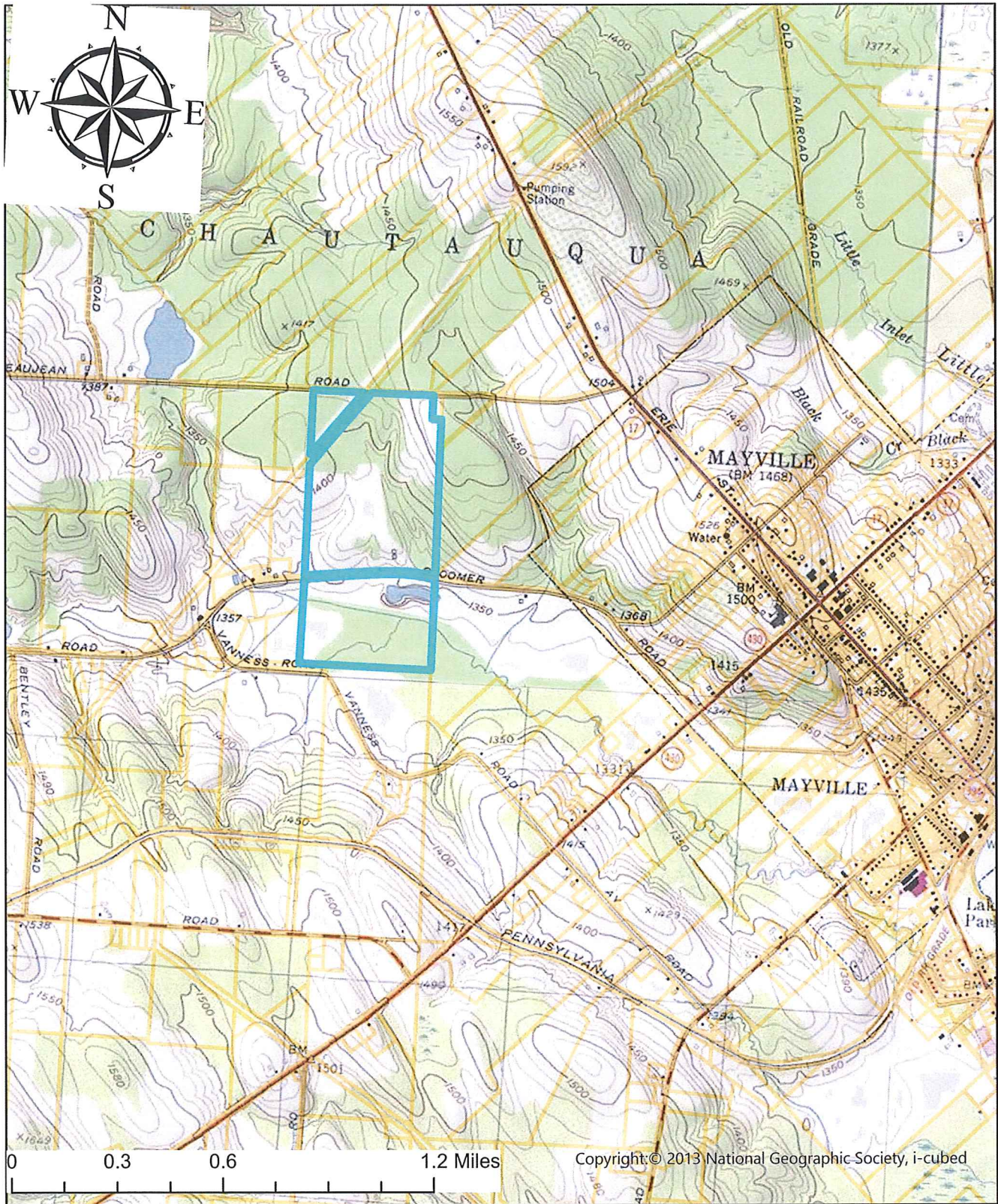

Location map for Mud creek dairy Source water protection project

Prepared by: Jeremy Woolson